

Hivatkozás

LAMILUX CI-System Glaselement FE rund



Harbour Terminal "Hafendüne", Norderney (Germany)

Essential info

Place / Country:	Norderney, Germany
Year:	2018
Building Type:	Harbour Terminal
Solutions:	CI System Glass Element FE in round design

The newly built harbour terminal on Norderney is modern and flooded with daylight thanks to LAMILUX Glass Elements in round design. A total of 21 Glass Elements were installed above the reception hall and the administration offices. 16 of these have a diameter of 100cm and the remaining 5 have a diameter of 180cm.

LAMILUX HEINRICH STRUNZ GMBH

Zehstraße 2 - Postafiók 1540 - 95105 Rehau/Németország - Telefon: +49/(0)92 83/5 95-0 - Fax: +49/(0)92 83/5 95-29 0

E-mail: information@lamilux.de - www.lamilux.de

Hivatkozás

LAMILUX CI-System Glaselement FE rund



Harbour Terminal "Hafendüne", Norderney (Germany)

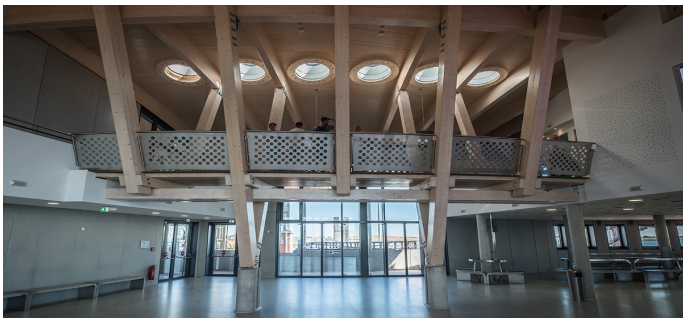

LAMILUX HEINRICH STRUNZ GMBH

Zehstraße 2 - Postafiók 1540 - 95105 Rehau/Németország - Telefon: +49/(0)92 83/5 95-0 - Fax: +49/(0)92 83/5 95-29 0

E-mail: information@lamilux.de - www.lamilux.de